

Installation Instructions

MEL-3232-SQ/MEL-3636-SQ/MEL-4040-SQ

SUGGESTED TOOLS AND MATERIALS

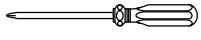

Screwdriver

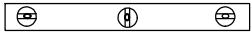

Level



Drill



Tape Measure



Safety Glasses



Pencil

PARTS & HAREWARE INCLUDED



Anchor 6x

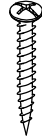

Screw 6x

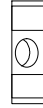

Level 1x

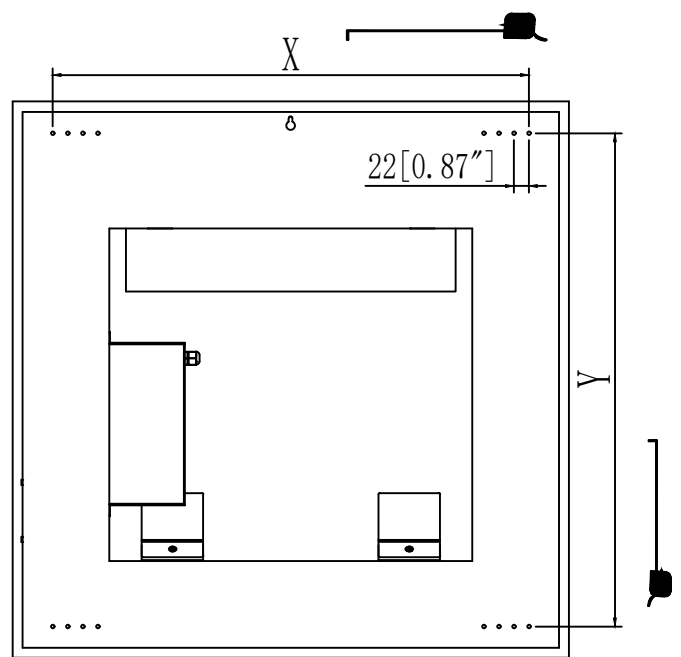
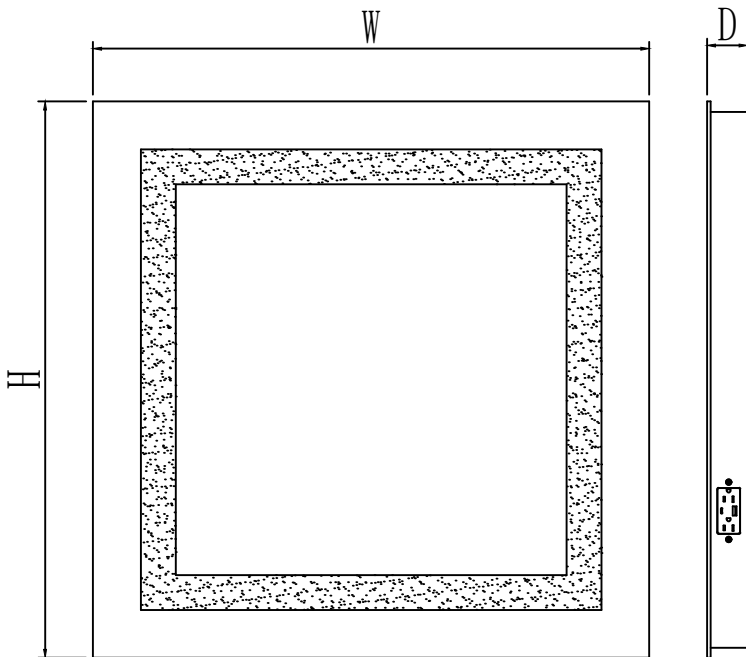

Installation Instructions

MEL-3232-SQ/MEL-3636-SQ/MEL-4040-SQ

SUGGESTED TOOLS AND MATERIALS

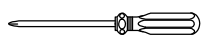

Screwdriver

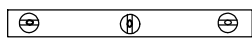

Level



Drill



Tape Measure

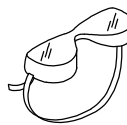

Safety Glasses



Pencil

PARTS & HAREWARE INCLUDED



Anchor 6x

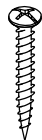

Screw 6x



Level 1x

INSTALLATION INSTRUCTIONS

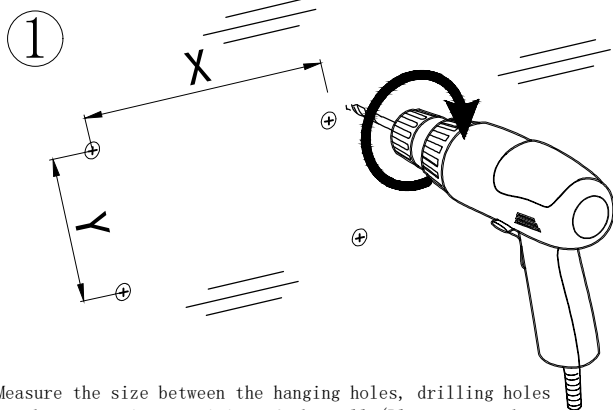

Measure the size between the hanging holes, drilling holes on the appropriate position of the wall. (Please note that the size of the mounting holes should be accurate)

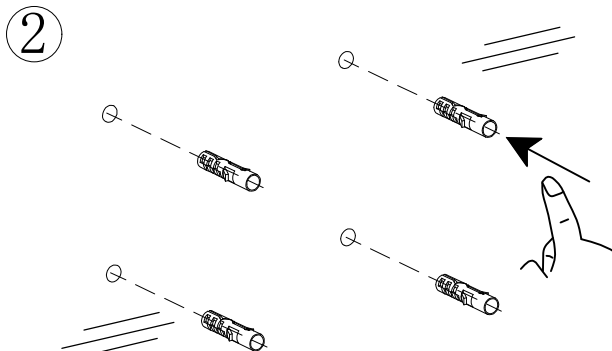

Insert the anchors into the wall(Use at least 4 anchors).

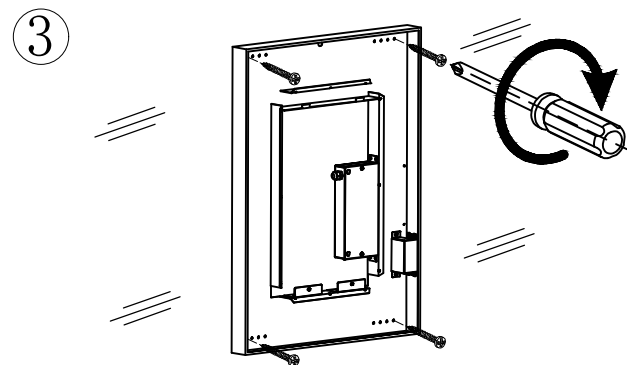

Screw metal chassis fixture to wall studs or other reinforce area that will support the weight of the fixture and mirror. Use 5x45mm screws to mount fixture to wall. Make sure the screws are fully tight.

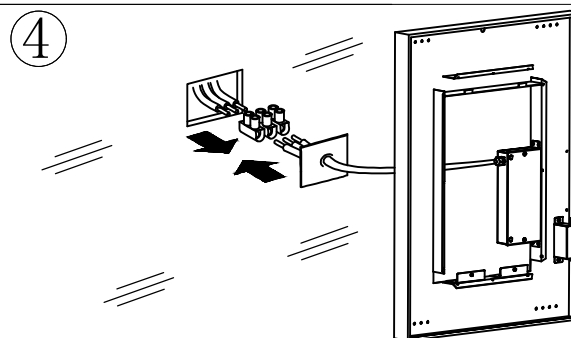

Wiring from light fitting

Neutral Wire			white(N)
Earth(green/yellow)			Green/yellow
Live Wire			black(L)

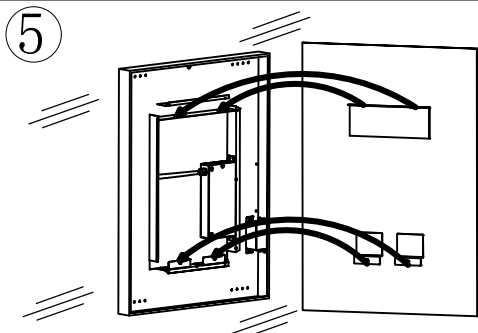

Lift the disassembled part of the mirror to a proper position, align the hook of the mirror with the buckle position on the chassis, and buckle it up and down. Then move the mirror to the left and right to check whether the mirror is installed to the buckle position on the chassis. As shown in Figure.

